

# FLORENCE CORPORATION

This Product Distributed By:

**U.S. Mail Supply, Inc.**

3065 North 124th Street

Brookfield, WI 53005-3857

Ph: 800-571-0147 / Fax: 800-589-1068

[www.usmailsupply.com](http://www.usmailsupply.com)



2018 Product Catalog Booklet

## STD-4C Mailbox Suites & Accessories



# STD-4C Mailbox Suites

## *The Key to Good Design*



The U.S. Postal Service Operations Manual provides the USPS with autonomy in determining the appropriate mode of delivery; which includes the location and type of equipment to be used. For multi-family new construction, that is most often the STD-4C mailbox.

As the first manufacturer to introduce a full USPS Approved line of mailboxes which met the mandatory USPS wall-mounted mailbox standard (STD) in 2006, Florence has continued to evolve the product line in order to keep pace with changing marketplace demands.

Our robust versatile™ 4C mailbox line was developed with a simple to use modular system that provides a very flexible solution for your individual project needs - taking the guesswork out of meeting the necessary USPS requirements and/or ADA Fair Housing requirements, too.

As an architecturally specified product, Florence takes the guesswork out of the process by providing standard pre-configured options for simple installations, or gives you the ability to custom-build a solution which will make your centralized mail center stand out from all the rest.



Florence is also pleased to offer you numerous industry exclusive standard features, finishes, and accessories; all providing greater design flexibility and installation solutions than any other STD-4C mail equipment available on the market today.

So, whether you are replacing an outdated mailbox installation, or starting a new construction project, Florence stands ready to assist you. Visit us online for simple-to-use resources that allow you to plan your own mailbox installation, view technical and installation information, and learn how to easily customize your project.



These rugged 4C mailboxes are weather-resistant and can be used indoors or out.

Or, contact an Authorized Florence Dealer for personalized assistance. These knowledgeable experts can help you find the right product for your needs, navigate local codes and accessibility, and some even help with installation work.

For architects, we offer robust BIM Objects and an industry unique online Revit Configurator, which allows you to create your own solution and export it as an RFA file for easy download into your existing design. Be sure to check out our 'how-to' video library, online resource toolkit, and take one of several continuing education courses for AIA credit.



Surface-mounted 4C mailboxes are perfect for limited wall depth projects.

# versatile™ 4C Mailboxes

*Flexibility without the fuss*



Florence versatile™ 4C mailboxes provide a simple, easy-to-use 'pre-configured' line of mailboxes and parcel lockers which all meet or exceed every security requirement of the USPS STD-4C regulation for wall-mounted mail receptacles. By providing different "suite" height options, adding the right module to your installation is quick and easy.

Offering more than 140 different individual modules to select from, plus the ability to configure any base module, Florence has the most robust line of USPS Approved 4C products and installation accessories on the market today.



## Product Design and Security Features

- Standard pre-configured modules with integrated parcel lockers in 12 different heights (as shown below)
- Thick, reinforced collection door to prevent break-ins
- Master front-loading door has interlocking, overlapping seams to prevent prying
- Integrated outgoing mail collection compartment with weather protection hood and anti-fishing comb
- One piece extruded hinge to prevent prying
- Solid aluminum frame protects adjacent customer/collection compartments
- Multi-unit connector kit hardware supplied with every module for easier installation across larger openings

**FLORENCE**  
EXCLUSIVE PRODUCT



- Hardy stainless steel latching hook cam on every tenant door with EXCLUSIVE double-latching cam on all oversized doors
- EXCLUSIVE double-latching parcel locking mechanism design for added door security and strength

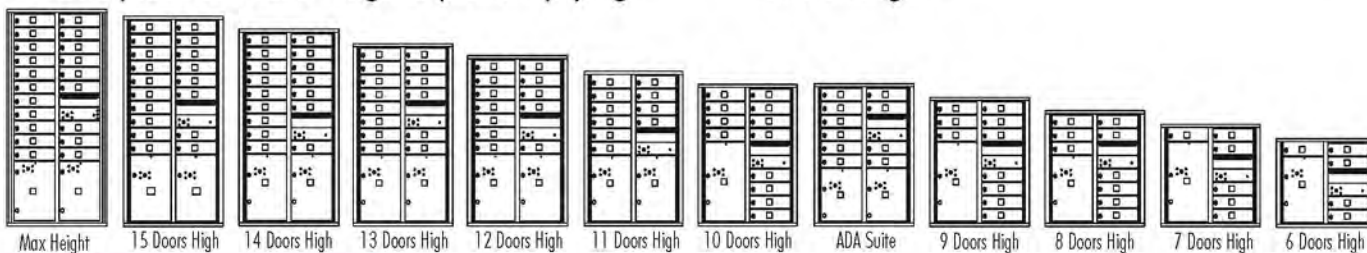

# STD-4C Mailboxes



Interlocking, overlapping seams to prevent prying



Heavy duty tenant cam lock with three keys



Standard decals or 3/4" H engraving



Integrated Outgoing Mail Slot with weather protection hood



Solid aluminum integrated outgoing mail collection compartment prepared for USPS installed Arrow Lock



Product and manufacturer ID serial tag



Easy release handle to open master gate



Stainless steel hold open door catch on each side of master gate



Fully integrated parcel locker(s) with key trapping lock



Aluminum comb prevents mail fishing in outgoing mail collection compartment



Rugged, weather-resistant powder coat finish



Heavy duty cam latches through frame for added security



# versatile™ 4C Mailboxes

## Plenty of Choices



The Florence versatile™ 4C mailbox line provides unsurpassed flexibility in creating your perfect centralized mail delivery center with nearly a limitless combination of options.

Begin by selecting the mailbox height and module for your needs (see module pages 18-29), choose accessory modules, ID, and color selections, and finally the manner in which it will be mounted.

## Module Choices

### USPS and Private STD-4C Mailboxes

Over 115 individual mailbox modules are available, all of which can be customized with oversized doors and lock options for both postal and private delivery applications.



### Collection Boxes

These secure modules complement your mailbox installation and are designed for all your collection needs; postal or private collection, x-rays, DVD/Blue Ray, books, etc.



### Recycling Bins

Keep the centralized mail center tidy by providing receptacles for the disposal of unwanted mail, or create a recycling center with these matching modules.



(Actual Size Shown)

## Door ID Options

**Decals:** All 4Cs come standard with silver adhesive decals which are 1-1/2"H x 1-3/4"W. Black lettering can contain up to five characters per decal.

**Engraving:** Custom engraving utilizes the USPS Standard *US Block* font and is 3/4" tall. All engraving can include up to 12 characters per line, up to two lines per door.



(Optional Engraving into Aluminum Door)

## Color Options

Customize your versatile™ 4C module with one of eight different architectural color options, all in a durable, powder coat finish.

Colors shown are representative of the actual powder coat finish but are limited by printing conditions and may vary slightly from finished product.



Antique Bronze (AB)



Black (BK)



Dark Bronze (DB)



Gold Speck (GS)



Postal Grey (PG)



Sandstone (SD)



Silver Speck (SS)



White (WH)

# versatile™ 4C Mailboxes

## Florence 4C Quick Reference Guide



All STD-4C compliant mailboxes must meet the U.S. Postal Service's (USPS) design and installation regulation in order to receive the designation *USPS Approved*. Accessibility regulations may vary locally and regionally; always consult local building codes for applicable accessibility requirements related to your mailbox project. (See page 30 for additional details.)

Sequential numbering (rather than assigning mailbox IDs that match apartment or house numbers) of mailbox compartments may allow greater flexibility in providing accessible mailbox compartments that meet accessibility regulations applicable to your project. It also provides greater security and privacy for residents.

Mounting at specified heights AFF (Above Finished Floor) ensure USPS installation requirements are met.

- If your installation is for USPS delivery and contains any tenant compartments in the bottom row, the minimum height from the floor is 28."
- If your installation contains no tenant compartments in the bottom row, you have the option to install at a minimum of 15" from the floor to be compliant with ADA and USPS requirements.

### versatile™ 4C Mailbox Height Options

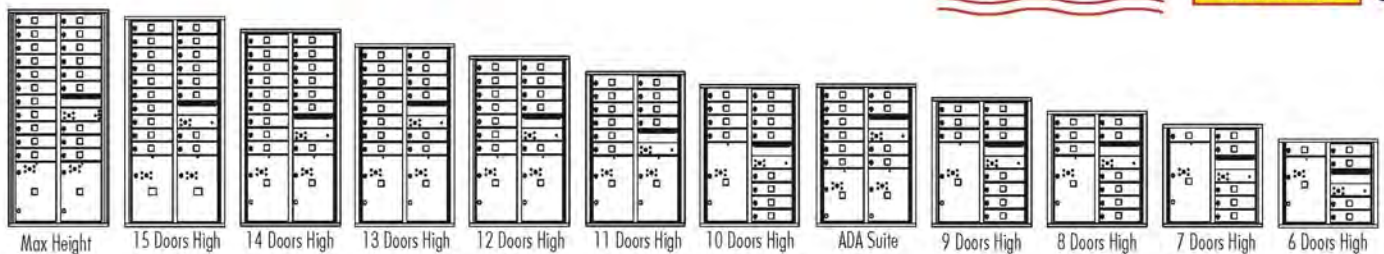

The reference module images and charts on the following pages show the proper installation heights for Florence's versatile™ 4C mailbox suites to help your project comply with USPS installation and accessibility codes. Drawings shown are for your quick reference only. For specific standards, consult with local authorities.



### Standard Lock

Cam-lock is USPS Approved and standard on all versatile™ 4C mailboxes.



### Top/Side Views For All Heights

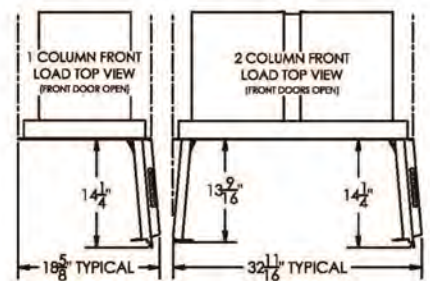
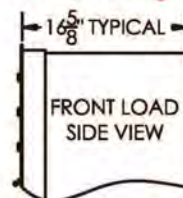

## MAX HEIGHT SUITE Actual: 56-1/2"H x 31-9/16"W (Double) or 17-1/2"W (Single) x 17"D / Rough Opening: 55-9/16"H x 30-5/16"W (Double) or 16-1/4"W (Single) x 17"D

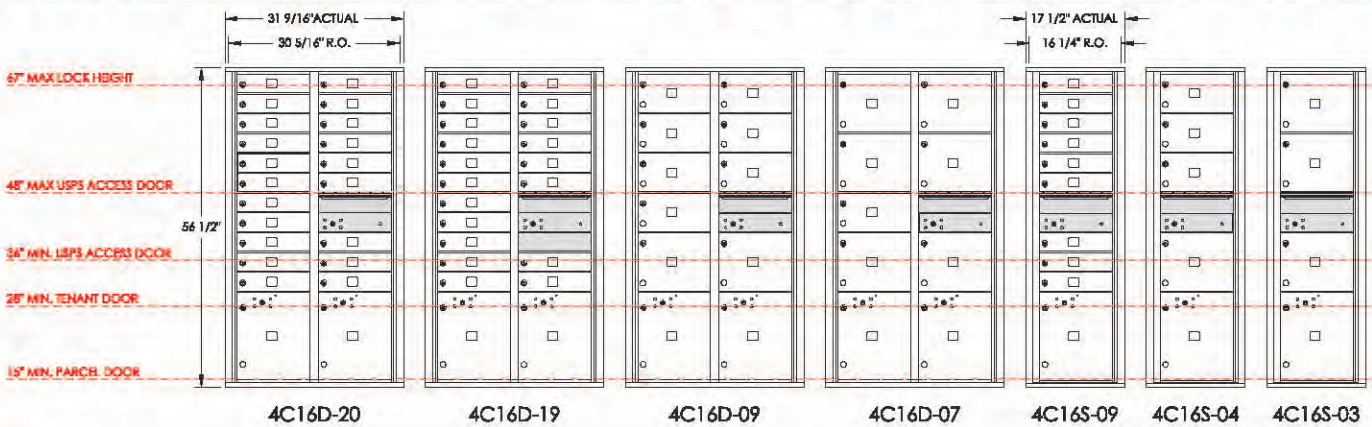

Floor

Model (Compartment Types)	4C16D-20 (20 MB1, 2 PL15)	4C16D-19 (19 MB1, 2 PL15)	4C16D-09 (7 MB2, 2 MB3, 2 PL15)	4C16D-07 (1 MB2, 6 MB3, 2 PL15)	4C16S-09 (9 MB1, 1 PL15)	4C16S-04 (3 MB2, 1 MB3, 1 PL15)	4C16S-03 (3 MB3, 1 PL15)
# Mailboxes (Total)	20	19	9	7	9	4	3
# Parcel Lockers (Total)	2	2	2	2	1	1	1
# Collection	1	1	1	1	1	1	1
# BINS	0	0	0	0	0	0	0
# Mailboxes Under 48"	8	7	3	3	3	1	1
Module Weight (lbs)	171	163	157	140	97	81	62

## 15 DOORS HIGH Actual: 54-3/4"H x 31-9/16"W (Double) or 17-1/2"W (Single) x 17"D / Rough Opening: 53-13/16"H x 30-5/16"W (Double) or 16-1/4"W (Single) x 17"D

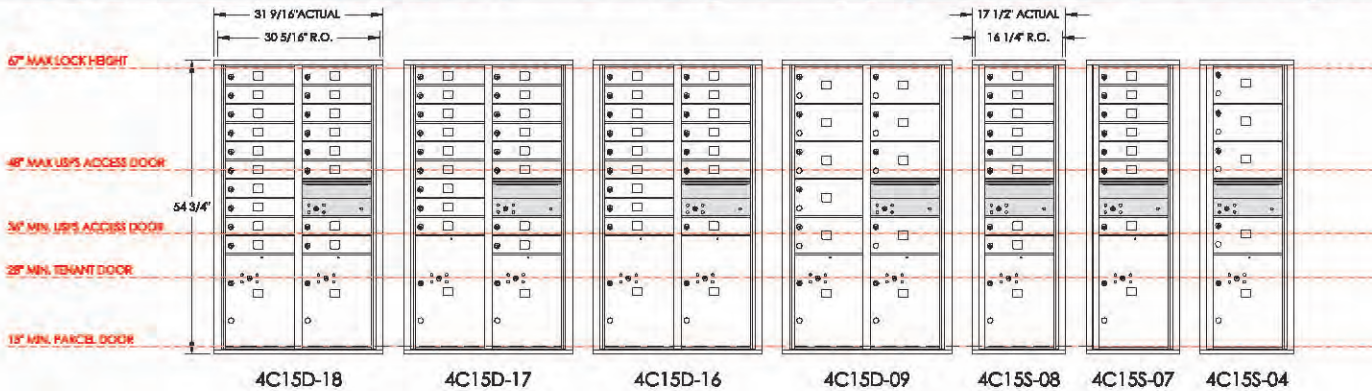

Floor

Model (Compartment Types)	4C15D-18 (18 MB1, 2 PL5)	4C15D-17 (17 MB1, 1 PL5, 1 PL6)	4C15D-16 (16 MB1, 2 PL6)	4C15D-09 (9 MB2, 2 PL5)	4C15S-08 (8 MB1, 1 PL5)	4C15S-07 (7 MB1, 1 PL6)	4C15S-04 (4 MB2, 1 PL5)
# Mailboxes (Total)	18	17	16	9	8	7	4
# Parcel Lockers (Total)	2	2	2	2	1	1	1
# Collection	1	1	1	1	1	1	1
# BINS	0	0	0	0	0	0	0
# Mailboxes Under 48"	8	7	6	3	3	2	1
Module Weight (lbs)	160	158	156	144	87	85	79

### NOTES:

All standard 4C mailbox modules shown above are fully configurable; visit [florencemailboxes.com/configure](http://florencemailboxes.com/configure) to quickly and easily create your custom solution.

See page 31 for mailbox (MB) and parcel locker (PL) compartment size definitions and configurable options.

Modules noted with an asterisk (\*) do not meet USPS installation specifications and are for private delivery.

All model numbers listed are for recessed-mount modules; add -P for Pedestal-mount modules at the end of the number; see page 34 for additional details.



Actual: 56-1/2"H x 31-9/16"W (Double) or 17-1/2"W (Single) x 17"D / Rough Opening: 55-9/16"H x 30-5/16"W (Double) or 16-1/4"W (Single) x 17"D **MAX HEIGHT SUITE**

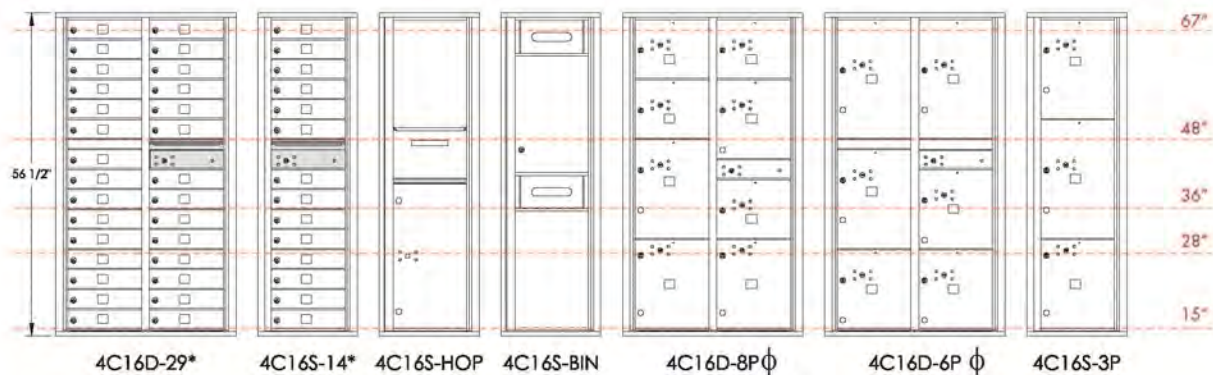

4C16D-29* (29 MB1)	4C16S-14* (14 MB1)	4C16S-HOP	4C16S-BIN	4C16D-8P φ (4 PL3, 1 PL4, 1 PL5, 2 PL15)	4C16D-6P φ (3 PL4, 1 PL5, 2 PL6)	4C16S-3P (1 PL15, 1 PL5, 1 PL6)	Model (Compartment Types)
29	14	0	0	0	0	0	# Mailboxes
0	0	0	0	8	6	3	# Parcel Lockers
1	1	1	0	0	0	0	# Collection
0	0	0	2	0	0	0	# BINS
17	8	0	0	0	0	0	# MB under 48"
170	96	76	65	113	105	58	Module Weight

Actual: 54-3/4"H x 31-9/16"W (Double) or 17-1/2"W (Single) x 17"D / Rough Opening: 53-13/16"H x 30-5/16"W (Double) or 16-1/4"W (Single) x 17"D **15 DOORS HIGH**



4C15D-28* (28 MB1)	4C15D-13* (11 MB2, 2 MB3)	4C15S-13* (13 MB1)	4C15S-06* (5 MB2, 1 MB3)	4C15S-HOP	4C15S-BIN	4C15S-3P (3 PL5)	Model (Compartment Types)
28	13	13	6	0	0	0	# Mailboxes
0	0	0	0	0	0	3	# Parcel Lockers
1	1	1	1	1	0	0	# Collection
0	0	0	0	0	2	0	# BINS
18	7	8	3	0	0	0	# MB under 48"
122	142	95	79	74	63	75	Module Weight

**NOTES:**

All standard 4C mailbox modules shown above are fully configurable; visit [florencemailboxes.com/configure](http://florencemailboxes.com/configure) to quickly and easily create your custom solution.  
See page 31 for mailbox (MB) and parcel locker (PL) compartment size definitions and configurable options.  
Modules noted with (\*) do not meet USPS installation specifications and are for private delivery; those noted with (φ) contain PL under the USPS required 15" tall - see page 31 for details.  
All model numbers listed are for recessed-mount modules; add -P for Pedestal-mount modules at the end of the number; see page 34 for additional details.

## 14 DOORS HIGH Actual: 51-1/4"H x 31-9/16"W (Double) or 17-1/2"W (Single) x 17"D / Rough Opening: 50-5/16"H x 30-5/16"W (Double) or 16-1/4"W (Single) x 17"D

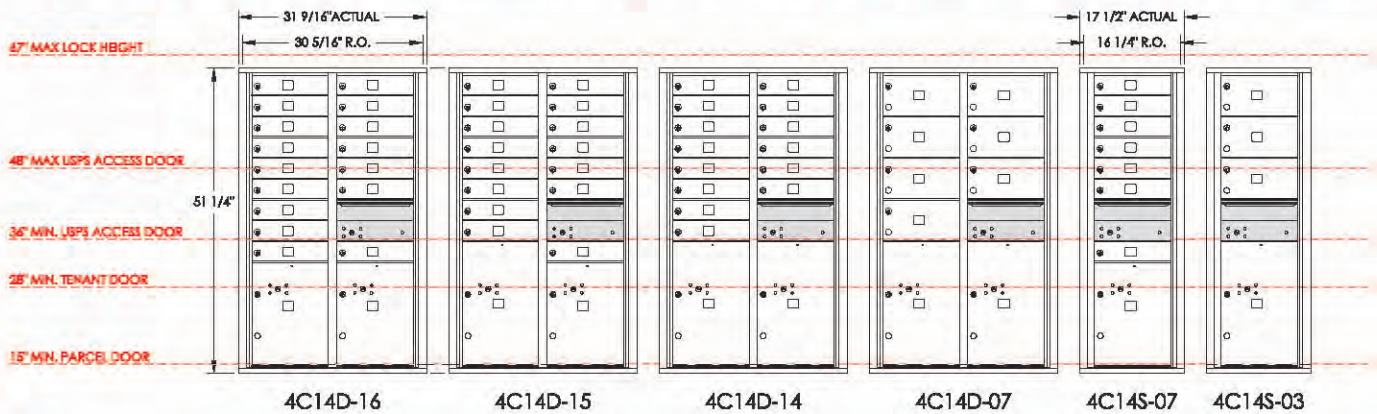

Model (Compartment Types)	4C14D-16 (16 MB1, 2 PL5)	4C14D-15 (15 MB1, 1 PL5, 1 PL6)	4C14D-14 (14 MB1, 2 PL6)	4C14D-07 (7 MB2, 2 PL6)	4C14S-07 (7 MB1, 1 PL5)	4C14S-03 (3 MB2, 1 PL6)
# Mailboxes (Total)	16	15	14	7	7	3
# Parcel Lockers (Total)	2	2	2	2	1	1
# Collection	1	1	1	1	1	1
# BINS	0	0	0	0	0	0
# Mailboxes Under 48"	8	7	6	3	3	1
Module Weight (lbs)	137	130	109	99	72	56

## 13 DOORS HIGH Actual: 47-3/4"H x 31-9/16"W (Double) or 17-1/2"W (Single) x 17"D / Rough Opening: 46-13/16"H x 30-5/16"W (Double) or 16-1/4"W (Single) x 17"D

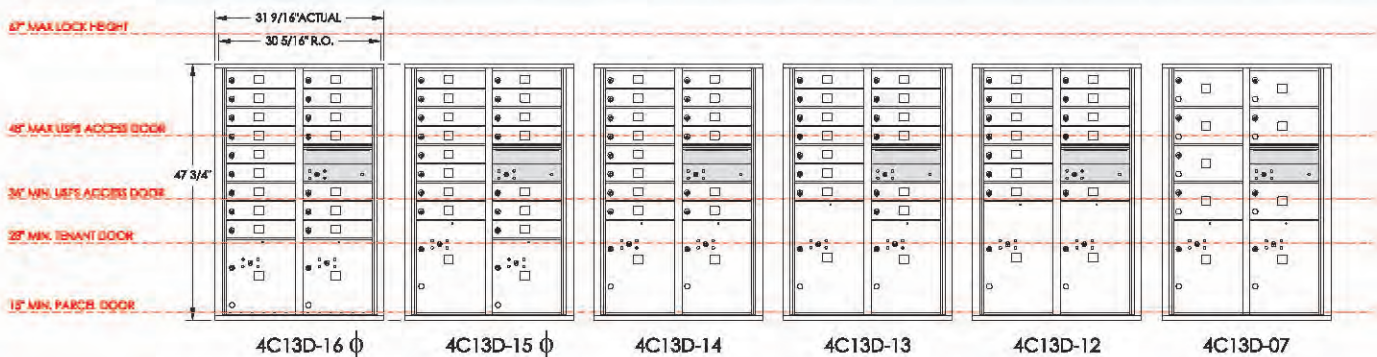

Model (Compartment Types)	4C13D-16 φ (16 MB1, 2 PL4)	4C13D-15 φ (15 MB1, 1 PL4, 1 PL5)	4C13D-14 (14 MB1, 2 PL5)	4C13D-13 (13 MB1, 1 PL5, 1 PL6)	4C13D-12 (12 MB1, 2 PL6)	4C13D-07 (7 MB2, 2 PL5)
# Mailboxes (Total)	16	15	14	13	12	7
# Parcel Lockers (Total)	2	2	2	2	2	2
# Collection	1	1	1	1	1	1
# BINS	0	0	0	0	0	0
# Mailboxes Under 48"	10	9	8	7	6	3
Module Weight (lbs)	129	127	125	123	121	114

### NOTES:

All standard 4C mailbox modules shown above are fully configurable; visit [florencemailboxes.com/configure](http://florencemailboxes.com/configure) to quickly and easily create your custom solution. See page 31 for mailbox (MB) and parcel locker (PL) compartment size definitions and configurable options. Modules noted with (\*) do not meet USPS installation specifications and are for private delivery; those noted with (φ) contain PL under the USPS required 15" tall - see page 31 for details. All model numbers listed are for recessed-mount modules; add -P for Pedestal-mount modules at the end of the number; see page 34 for additional details.

Actual: 51-1/4"H x 31-9/16"W (Double) or 17-1/2"W (Single) x 17"D / Rough Opening: 50-5/16"H x 30-5/16"W (Double) or 16-1/4"W (Single) x 17"D **14 DOORS HIGH**

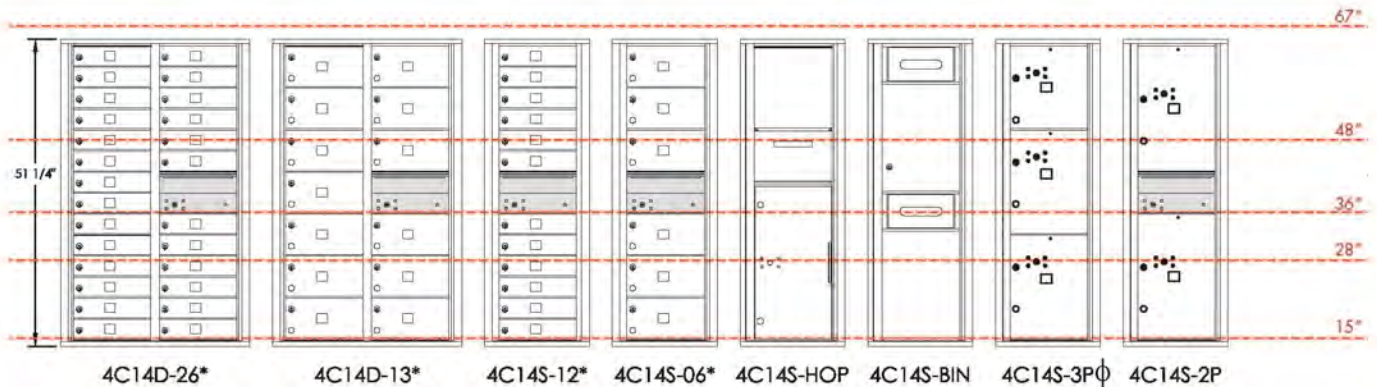

4C14D-26* (26 MB1)	4C14D-13* (13 MB2)	4C14S-12* (12 MB1)	4C14S-06* (6 MB2)	4C14S-HOP	4C14S-BIN	4C14S-3P φ (1 PL4, 2 PL5)	4C14S-2P (2 PL6)	Model (Compartment Types)
26	13	12	6	0	0	0	0	# Mailboxes
0	0	0	0	0	0	3	2	# Parcel Lockers
1	1	1	1	1	0	0	1	# Collection
0	0	0	0	0	2	0	0	# BINS
18	9	8	4	0	0	0	0	# MB under 48"
145	101	76	56	72	58	56	55	Module Weight

Actual: 47-3/4"H x 31-9/16"W (Double) or 17-1/2"W (Single) x 17"D / Rough Opening: 46-13/16"H x 30-5/16"W (Double) or 16-1/4"W (Single) x 17"D **13 DOORS HIGH**

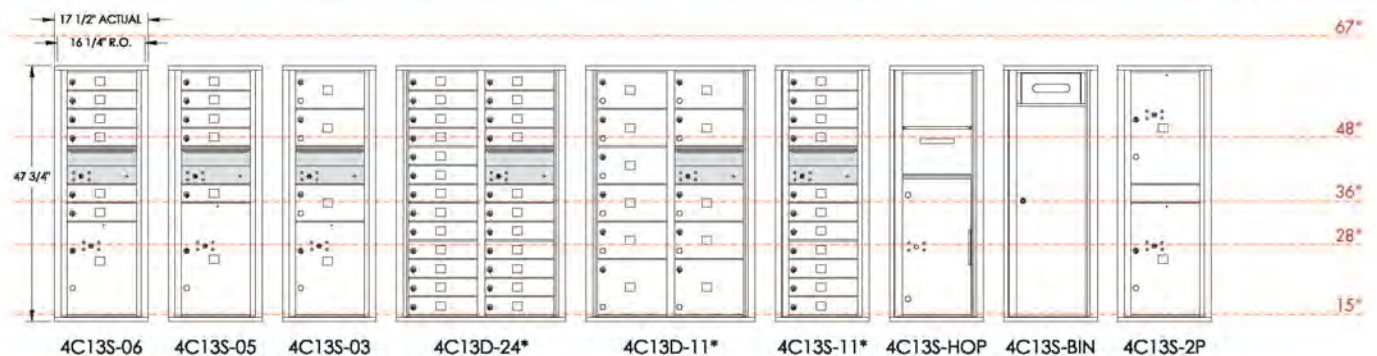

4C13S-06 (6 MB1, 1 PL5)	4C13S-05 (5 MB1, 1 PL6)	4C13S-03 (3 MB2, 1 PL5)	4C13D-24* (24 MB1)	4C13D-11* (9 MB2, 2 MB3)	4C13S-11* (11 MB1)	4C13S-HOP	4C13S-BIN	4C13S-2P (2 PL6)	Model (Compartment Types)
6	5	3	24	11	11	0	0	0	# Mailboxes
1	1	1	0	0	0	0	0	2	# Parcel Lockers
1	1	1	1	1	1	1	0	0	# Collection
0	0	0	0	0	0	0	1	0	# BINS
3	2	1	18	7	8	0	0	0	# MB under 48"
68	67	64	133	112	72	69	45	57	Module Weight

**NOTES:**

All standard 4C mailbox modules shown above are fully configurable; visit [florencemailboxes.com/configure](http://florencemailboxes.com/configure) to quickly and easily create your custom solution.

See page 31 for mailbox (MB) and parcel locker (PL) compartment size definitions and configurable options.

Modules noted with (\*) do not meet USPS installation specifications and are for private delivery; those noted with (φ) contain PL under the USPS required 15" tall - see page 31 for details.

All model numbers listed are for recessed-mount modules; add -P for Pedestal-mount modules at the end of the number; see page 34 for additional details.

## 12 DOORS HIGH Actual: 44-1/4"H x 31-9/16"W (Double) or 17-1/2"W (Single) x 17"D / Rough Opening: 43-5/16"H x 30-5/16"W (Double) or 16-1/4"W (Single) x 17"D

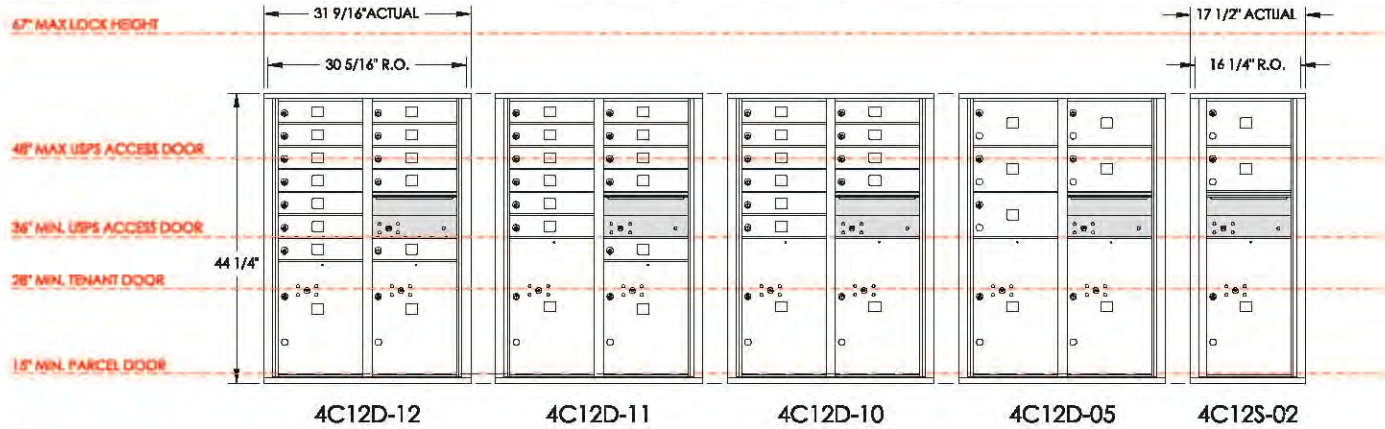

Floor

Model (Compartment Types)	4C12D-12 (12 MB1, 2 PL5)	4C12D-11 (11 MB1, 1 PL5, 1 PL6)	4C12D-10 (10 MB1, 2 PL6)	4C12D-05 (5 MB2, 2 PL6)	4C12S-02 (2 MB2, 1 PL6)
# Mailboxes (Total)	12	11	10	5	2
# Parcel Lockers (Total)	2	2	2	2	1
# Collection	1	1	1	1	1
# BINS	0	0	0	0	0
# Mailboxes Under 48"	8	7	6	3	1
Module Weight (lbs)	116	114	112	104	59

## 11 DOORS HIGH Actual: 40-3/4"H x 31-9/16"W (Double) or 17-1/2"W (Single) x 17"D / Rough Opening: 39-13/16"H x 30-5/16"W (Double) or 16-1/4"W (Single) x 17"D

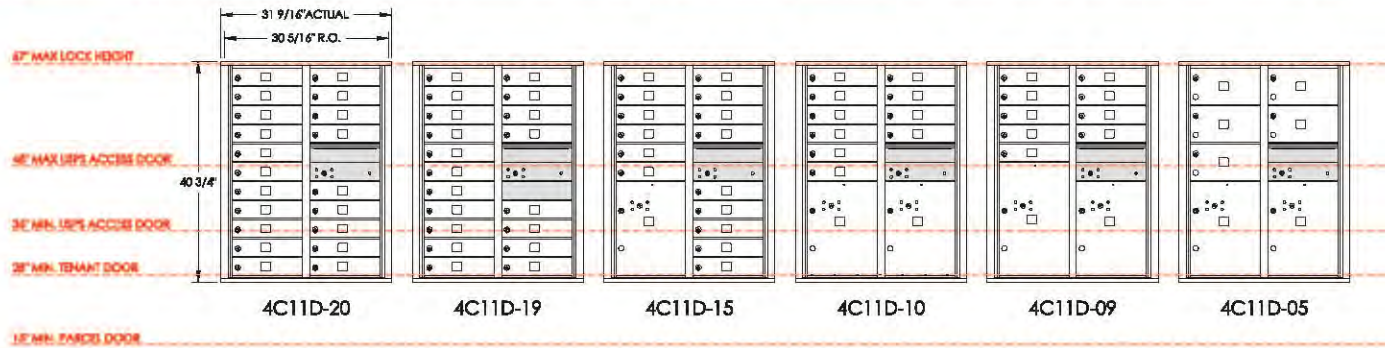

Floor

Model (Compartment Types)	4C11D-20 (20 MB1)	4C11D-19 (19 MB1)	4C11D-15 (15 MB1, 1 PL5)	4C11D-10 (10 MB1, 2 PL5)	4C11D-09 (9 MB1, 1 PL5, 1 PL6)	4C11D-05 (5 MB2, 2 PL5)
# Mailboxes (Total)	20	19	15	10	9	5
# Parcel Lockers (Total)	0	0	1	2	2	2
# Collection	1	1	1	1	1	1
# BINS	0	0	0	0	0	0
# Mailboxes Under 48"	11	10	6	1	0	0
Module Weight (lbs)	123	122	119	115	113	106

### NOTES:

All standard 4C mailbox modules shown above are fully configurable; visit [florencemailboxes.com/configure](http://florencemailboxes.com/configure) to quickly and easily create your custom solution.

See page 31 for mailbox (MB) and parcel locker (PL) compartment size definitions and configurable options.

Modules noted with an asterisk (\*) do not meet USPS installation specifications and are for private delivery.

All model numbers listed are for recessed-mount; add -P for Pedestal-mount modules at the end of the number; see page 34 for additional details.

Actual: 44-1/4"H x 31-9/16"W (Double) or 17-1/2"W (Single) x 17"D / Rough Opening: 43-5/16"H x 30-5/16"W (Double) or 16-1/4"W (Single) x 17"D **12 DOORS HIGH**



4C12D-22* (22 MB1)	4C12S-10* (10 MB1)	4C12S-HOP	4C12S-BIN	4C12D-4P (4 PL6)	4C12S-2P (2 PL6)	Model (Compartment Types)
22	10	0	0	0	0	# Mailboxes
0	0	0	0	4	2	# Parcel Lockers
1	1	1	0	0	0	# Collection
0	0	0	1	0	0	# BINS
18	8	0	0	0	0	# MB under 48"
124	68	66	45	97	53	Module Weight

Actual: 40-3/4"H x 31-9/16"W (Double) or 17-1/2"W (Single) x 17"D / Rough Opening: 39-13/16"H x 30-5/16"W (Double) or 16-1/4"W (Single) x 17"D **11 DOORS HIGH**



4C11S-09 (9 MB1)	4C11S-04 (4 MB1, 1 PL5)	4C11S-02 (2 MB2, 1 PL5)	4C11S-HOP	4C11S-BIN	4C11D-4P (2 PL5, 2 PL6)	4C11S-2P (1 PL5, 1 PL6)	Model (Compartment Types)
9	4	2	0	0	0	0	# Mailboxes
0	1	1	0	0	4	2	# Parcel Lockers
1	1	1	1	0	0	0	# Collection
0	0	0	0	1	0	0	# BINS
5	0	0	0	0	0	0	# MB under 48"
56	53	50	65	45	99	45	Module Weight

**NOTES:**

All standard 4C mailbox modules shown above are fully configurable; visit [florencemailboxes.com/configure](http://florencemailboxes.com/configure) to quickly and easily create your custom solution. See page 31 for mailbox (MB) and parcel locker (PL) compartment size definitions and configurable options. Modules noted with an asterisk (\*) do not meet USPS installation specifications and are for private delivery. All model numbers listed are for recessed-mount modules; add -P for Pedestal-mount modules at the end of the number; see page 34 for additional details.

## 10 DOORS HIGH

Actual: 37-1/4"H x 31-9/16"W (Double) or 17-1/2"W (Single) x 17"D / Rough Opening: 36-5/16"H x 30-5/16"W (Double) or 16-1/4"W (Single) x 17"D

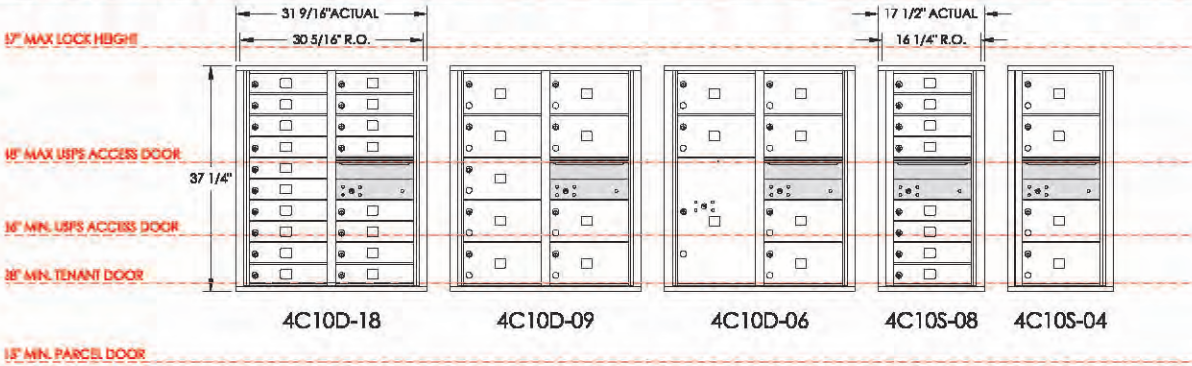

Model (Compartment Types)	4C10D-18 (18 MB1)	4C10D-09 (9 MB2)	4C10D-06 (6 MB2, 1 PL6)	4C10S-08 (8 MB1)	4C10S-04 (4 MB2)
# Mailboxes (Total)	18	9	6	8	4
# Parcel Lockers (Total)	0	0	1	0	0
# Collection	1	1	1	1	1
# BINS	0	0	0	0	0
# Mailboxes Under 48"	10	5	2	4	2
Module Weight (lbs)	97	84	83	56	47

## 9 HIGH

Actual: 33-3/4"H x 31-9/16"W (Double) or 17-1/2"W (Single) x 17"D / Rough Opening: 32-13/16"H x 30-5/16"W (Double) or 16-1/4"W (Single) x 17"D

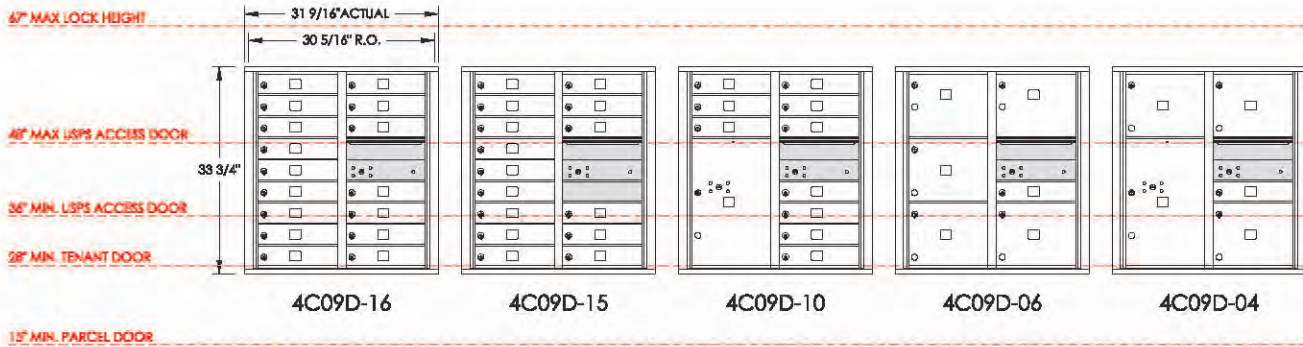

Model (Compartment Types)	4C09D-16 (16 MB1)	4C09D-15 (15 MB1)	4C09D-10 (10 MB1, 1 PL6)	4C09D-06 (1 MB1, 5 MB3)	4C09D-04 (1 MB1, 3 MB3, 1 PL6)
# Mailboxes (Total)	16	15	10	6	4
# Parcel Lockers (Total)	0	0	1	0	1
# Collection	1	1	1	1	1
# BINS	0	0	0	0	0
# Mailboxes Under 48"	10	9	4	4	2
Module Weight (lbs)	89	88	84	75	76

### NOTES:

All standard 4C mailbox modules shown above are fully configurable; visit [florencemailboxes.com/configure](http://florencemailboxes.com/configure) to quickly and easily create your custom solution. See page 31 for mailbox (MB) and parcel locker (PL) compartment size definitions and configurable options. All model numbers listed are for recessed-mount modules; add -P for Pedestal-mount modules at the end of the number; see page 34 for additional details.

Actual: 37-1/4"H x 31-9/16"W (Double) or 17-1/2"W (Single) x 17"D / Rough Opening: 36-5/16"H x 30-5/16"W (Double) or 16-1/4"W (Single) x 17"D

**10 DOORS HIGH**



4C10S-BIN	4C10S-HOP	4C10D-4P (4 PL5)	Model (Compartment Types)
0	0	0	# Mailboxes
0	0	4	# Parcel Lockers
1	0	0	# Collection
0	1	0	# BINS
0	0	0	# MB under 48"
41	52	80	Module Weight

## Mailbox Configurator

 [florencemailboxes.com/configure](http://florencemailboxes.com/configure)

Florence offers an industry unique online Revit mailbox configurator you can use to create your own versatile™ 4C installation.

This drag and drop tool will help guide you step-by-step, provide you with BIM and/or CAD drawings of your creation, and give you the ability to submit it for a quote.

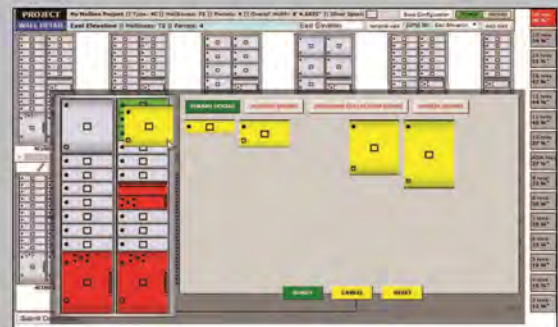

Actual: 33-3/4"H x 31-9/16"W (Double) or 17-1/2"W (Single) x 17"D / Rough Opening: 32-13/16"H x 30-5/16"W (Double) or 16-1/4"W (Single) x 17"D **9 HIGH**



4C09S-07 (7 MB1)	4C09S-02 (2 MB1, 1 PL5)	4C09S-HOP	4C09S-BIN	4C09D-4P (2 PL4, 2 PL5)	4C09S-2P (1 PL4, 1 PL5)	Model (Compartment Types)
7	2	0	0	0	0	# Mailboxes
0	1	0	0	4	2	# Parcel Lockers
1	1	1	0	0	0	# Collection
0	0	0	1	0	0	# BINS
4	0	0	0	0	0	# MB under 48"
48	45	52	41	76	40	Module Weight

**NOTES:**

All standard 4C mailbox modules shown above are fully configurable; visit [florencemailboxes.com/configure](http://florencemailboxes.com/configure) to quickly and easily create your custom solution. See page 31 for mailbox (MB) and parcel locker (PL) compartment size definitions and configurable options. All model numbers listed are for recessed-mount modules; add -P for Pedestal-mount modules at the end of the number; see page 34 for additional details.

# versatile™ 4C mailbox suites

**8 HIGH** Actual: 30-1/4"H x 31-9/16"W (Double) or 17-1/2"W (Single) x 17"D / Rough Opening: 29-5/16"H x 30-5/16"W (Double) or 16-1/4"W (Single) x 17"D

67" MAX LOCK HEIGHT

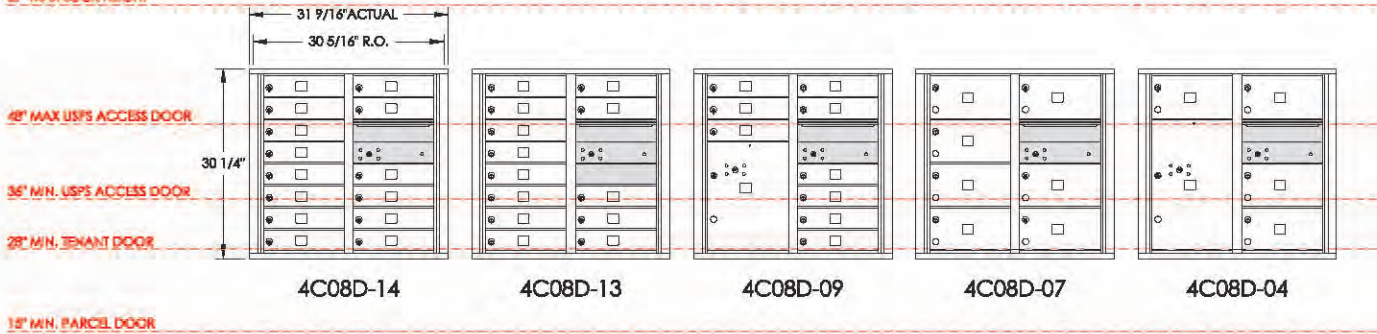

Floor

Model (Compartment Types)	4C08D-14 (14 MB1)	4C08D-13 (13 MB1)	4C08D-09 (9 MB1, 1 PL5)	4C08D-07 (7 MB2)	4C08D-04 (4 MB2, 1 PL6)
# Mailboxes (Total)	14	13	9	7	4
# Parcel Lockers (Total)	0	0	1	0	1
# Collection	1	1	1	1	1
# BINS	0	0	0	0	0
# Mailboxes Under 48"	10	9	5	5	2
Module Weight (lbs)	81	80	78	72	71

**7 HIGH** Actual: 26-3/4"H x 31-9/16"W (Double) or 17-1/2"W (Single) x 17"D / Rough Opening: 25-13/16"H x 30-5/16"W (Double) or 16-1/4"W (Single) x 17"D

67" MAX LOCK HEIGHT

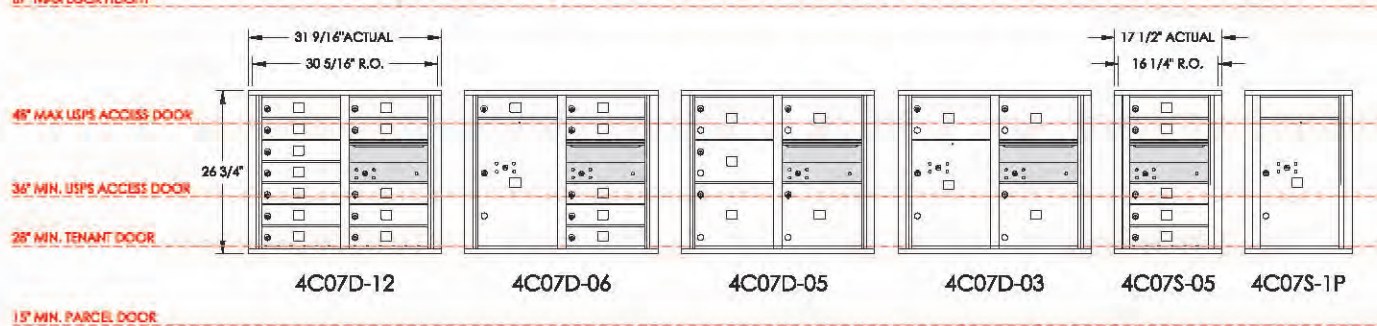

Floor

Model (Compartment Types)	4C07D-12 (12 MB1)	4C07D-06 (6 MB1, 1 PL6)	4C07D-05 (3 MB2, 2 MB3)	4C07D-03 (2 MB2, 1 MB3, 1 PL5)	4C07S-05 (5 MB1)	4C07S-1P (1 PL6)
# Mailboxes (Total)	12	6	5	3	5	0
# Parcel Lockers (Total)	0	1	0	1	0	1
# Collection	1	1	1	1	1	0
# BINS	0	0	0	0	0	0
# Mailboxes Under 48"	10	4	3	1	4	0
Module Weight (lbs)	73	68	64	65	40	32

**NOTES:**

All standard 4C mailbox modules shown above are fully configurable; visit [florencemailboxes.com/configure](http://florencemailboxes.com/configure) to quickly and easily create your custom solution. See page 31 for mailbox (MB) and parcel locker (PL) compartment size definitions and configurable options. All model numbers listed are for recessed-mount modules; add -P for Pedestal-mount modules at the end of the number; see page 34 for additional details.



Actual: 30-1/4"H x 31-9/16"W (Double) or 17-1/2"W (Single) x 17"D / Rough Opening: 29-5/16"H x 30-5/16"W (Double) or 16-1/4"W (Single) x 17"D **8 HIGH**

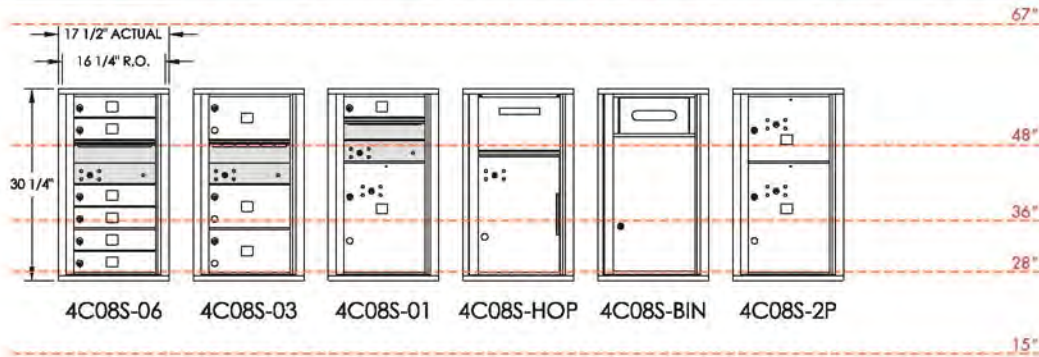

4C08S-06 (6 MB1)	4C08S-03 (3 MB2)	4C08S-01 (1 MB1, 1 PLS)	4C08S-HOP	4C08S-BIN	4C08S-2P (1 PL3, 1 PLS)	Model (Compartment Types)
6	3	1	0	0	0	# Mailboxes
0	0	1	0	0	2	# Parcel Lockers
1	1	1	1	0	0	# Collection
0	0	0	0	1	0	# BINS
4	2	0	0	0	0	# MB under 48"
44	40	40	52	44	37	Module Weight

## USPS Releases New National Delivery Planning Guide for Builders and Developers

The U.S. Postal Service's new planning guide outlines national delivery standards to assist builders and developers with planning mail delivery for new customer addresses. Whether your new development project is residential or commercial, this new USPS guide provides information about important planning considerations such as location, space allowance and the types of mailbox equipment options approved by the Postal Service for use in new construction.

To review USPS planning guidelines that apply to your specific project, download the guide from USPS Growth Management at [www.USPS.com](http://www.USPS.com) and click on About USPS/What We are Doing/Current Initiatives/Growth Management.

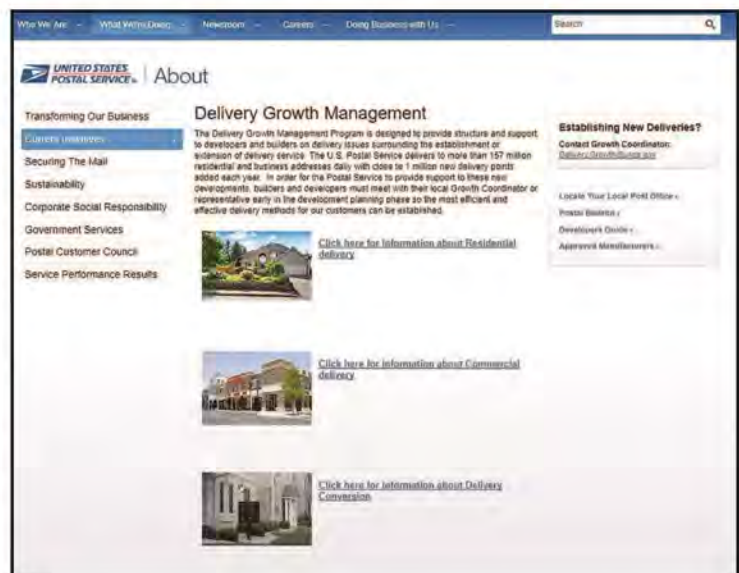

Ensuring adequate space and convenient locations for your customer's mail service by planning early for mail delivery in your new development is simply good planning. When you have questions, the Florence team is here to assist every step of the way.

# versatile™ 4C mailbox suites: ADA Compliant Heights

## 10H / ADA MAX

Actual: 37-1/4"H x 31-9/16"W (Double) or 17-1/2"W (Single) x 17"D / Rough Opening: 36-5/16"H x 30-5/16"W (Double) or 16-1/4"W (Single) x 17"D

67" MAX LOCK HEIGHT

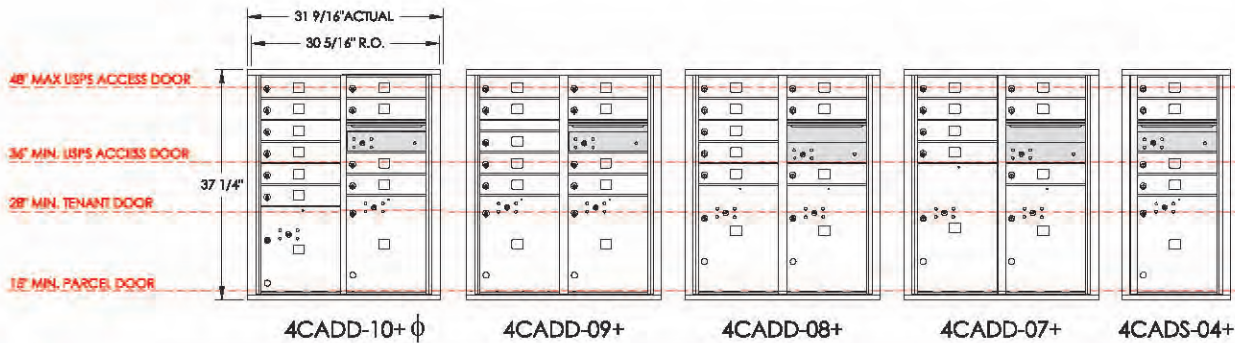

Floor

Model (Compartment Types)	4CADD-10+ φ (10 MB1, 1 PL4, 1 PL5)	4CADD-09+ (9 MB1, 2 PL5)	4CADD-08+ (8 MB1, 2 PL5)	4CADD-07+ (7 MB1, 1 PL5, 1 PL6)	4CADS-04+ (4 MB1, 1 PL5)
# Mailboxes (Total)	10	9	8	7	4
# Parcel Lockers (Total)	2	2	2	2	1
# Collection	1	1	1	1	1
# BINS	0	0	0	0	0
# Mailboxes Under 48"	10	9	8	7	4
Module Weight (lbs)	91	96	88	89	55

## 6 HIGH/ADA

Actual: 23-1/4"H x 31-9/16"W (Double) or 17-1/2"W (Single) x 17"D / Rough Opening: 22-5/16"H x 30-5/16"W (Double) or 16-1/4"W (Single) x 17"D

67" MAX LOCK HEIGHT



15" MIN. PARCEL DOOR

Floor

Model (Compartment Types)	4C06D-10+ (10 MB1)	4C06D-09+ (9 MB1)	4C06D-05+ (5 MB1, 1 PL5)	4C06D-05X+ (5 MB2)	4C06D-04+ (4 MB1, 1 PL6)
# Mailboxes (Total)	10	9	5	5	4
# Parcel Lockers (Total)	0	0	1	0	1
# Collection	1	1	1	1	1
# BINS	0	0	0	0	0
# Mailboxes Under 48"	10	9	5	5	4
Module Weight (lbs)	66	65	59	62	61

### NOTES:

All standard 4C mailbox modules shown above are fully configurable; visit [florencemailboxes.com/configure](http://florencemailboxes.com/configure) to quickly and easily create your custom solution.

See page 31 for mailbox (MB) and parcel locker (PL) compartment size definitions and configurable options.

Modules noted with (\*) do not meet USPS installation specifications and are for private delivery; those noted with (φ) contain PL under the USPS required 15" tall - see page 31 for details.

All model numbers listed are for recessed-mount modules; add -P for Pedestal-mount modules at the end of the number; see page 34 for additional details.

Actual: 37-1/4"H x 31-9/16"W (Double) or 17-1/2"W (Single) x 17"D / Rough Opening: 36-5/16"H x 30-5/16"W (Double) or 16-1/4"W (Single) x 17"D

**10H / ADA MAX**

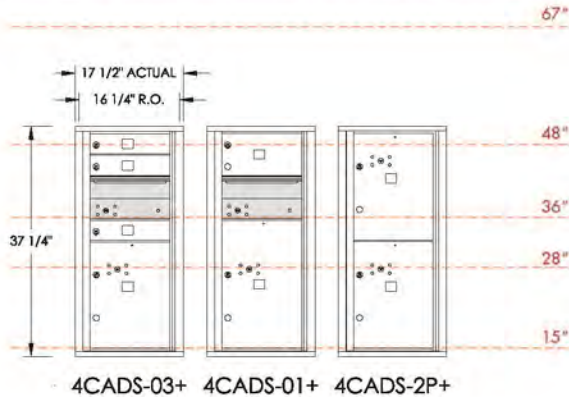

4CADS-03+	4CADS-01+	4CADS-2P+	Model
(3 MB1, 1 PL5)	(1 MB2, 1 PL6)	(2 PL5)	(Compartment Types)
3	1	0	# Mailboxes
1	1	2	# Parcel Lockers
1	1	0	# Collection
0	0	0	# BINS
3	1	0	# MB under 48"
49	46	43	Module Weight

## Designing Compliant Mailrooms

For interior mailrooms, the ADA specifies that at least 5% of the total mailboxes must meet accessibility guidelines with installation heights 15" to 48".

Local regulations may override this percentage and require 100% compliance. Typically, it is the local jurisdiction codes office/inspector that will designate if an installation must meet only the minimum ADA requirement of 5% or if it should be 100% compliant.

See page 30 for additional guidelines.

ADA Standards, Section 228.2

Actual: 23-1/4"H x 31-9/16"W (Double) or 17-1/2"W (Single) x 17"D / Rough Opening: 22-5/16"H x 30-5/16"W (Double) or 16-1/4"W (Single) x 17"D

**6 HIGH/ADA**

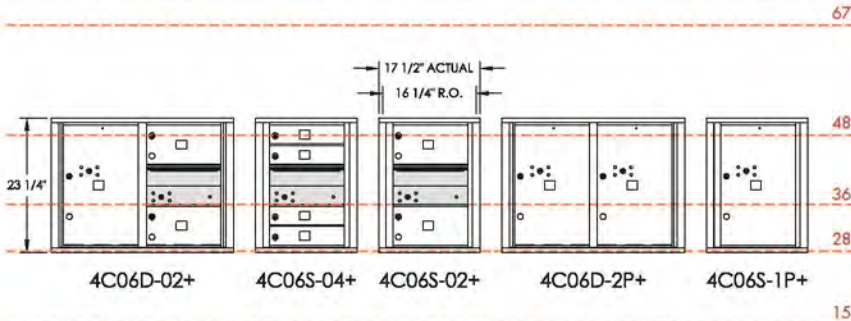

4C06D-02+	4C06S-04+	4C06S-02+	4C06D-2P+	4C06S-1P+	Model
(2 MB2, 1 PL6)	(4 MB1)	(2 MB2)	(2 PL6)	(1 PL6)	(Compartment Types)
2	4	2	0	0	# Mailboxes
1	0	0	2	1	# Parcel Lockers
1	1	1	0	0	# Collection
0	0	0	0	0	# BINS
2	4	2	0	0	# MB under 48"
58	36	33	53	28	Module Weight



**NOTES:**

All standard 4C mailbox modules shown above are fully configurable; visit [florencemailboxes.com/configure](http://florencemailboxes.com/configure) to quickly and easily create your custom solution. See page 31 for mailbox (MB) and parcel locker (PL) compartment size definitions and configurable options. Modules noted with a plus (+) meet Fair Housing ADA installation requirements. All model numbers listed are for recessed-mount modules; add -P for Pedestal-mount modules at the end of the number; see page 34 for additional details.

# INSTALLATION AND ACCESSIBILITY REFERENCES

Designing appropriate accessibility into every feature of a facility is a key consideration for any project, and how the mailboxes are installed into that facility is no exception. Plus, all wall-mounted mailboxes which will be serviced by the U.S. Postal Service (USPS) must also be installed according to specifications as outlined in the USPS STD-4C regulation.

To assist you with selecting mailboxes that meet the specific requirements of your project, details related to installed heights are noted on the Florence versatile™ 4C mailbox modules references on pages 18 - 29. Below are also the quick references related to accessible uses and USPS requirements to help you in determining your project layout and design.

## Meeting USPS Installation Requirements

Florence Corporation USPS Approved 4C mailbox products are designed to adhere to STD-4C regulations. To ensure your project complies with USPS regulations for wall-mounted mailboxes, your mailbox center must be installed according to the following U.S. Postal Service guidelines:

Installation requirements specified in the U.S. Postal Service STD-4C regulation are outlined below:

1. At least one customer compartment shall be positioned less than 48 inches above the finished floor.
2. No parcel locker compartment (interior bottom shelf) shall be positioned less than 15 inches above the finished floor.
3. No customer lock shall be located more than 67 inches above the finished floor.
4. No customer compartment (interior bottom shelf) shall be positioned less than 28 inches above the finished floor.
5. The USPS Arrow lock shall be located between 36 and 48 inches above the finished floor.

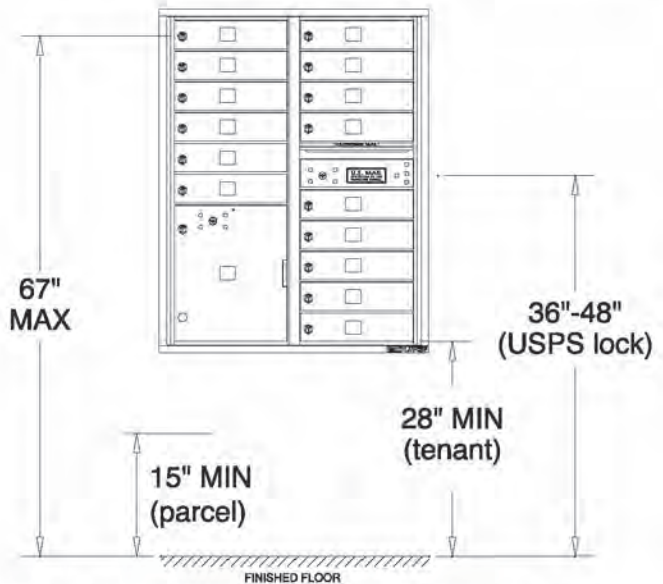

Standards Governing the Design of Wall-Mounted Centralized Mail Receptacles. Federal Register/Vol. 69, No 171/September 3, 2004  
 Rules and Regulations POSTAL SERVICE, 39 CFR Part 111. [www.gpo.gov/fdsys/pkg/FR-2004-09-03/pdf/04-19781.pdf](http://www.gpo.gov/fdsys/pkg/FR-2004-09-03/pdf/04-19781.pdf)

## Meeting ADA Installation Requirements

Accessibility regulations may vary by type of facility and by governing jurisdictions. Therefore, always consult local building officials and codes for applicable accessibility requirements that could affect your mailbox project. Below are industry references for your convenience.

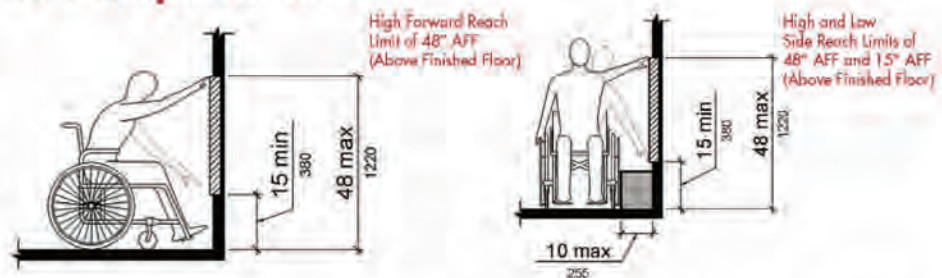

2010 ADA Standards for Accessible Design, Department of Justice Code of Federal Regulations, ADA CHAPTER 2: SCOPING REQUIREMENTS, 228.2 Mail Boxes: Where mail boxes are provided in an interior location, at least 5 percent, but no fewer than one, of each type shall comply with 309. In residential facilities, where mail boxes are provided for each residential dwelling unit, mail boxes complying with 309 shall be provided for each residential dwelling unit required to provide mobility features complying with 809.2 through 809.4.

The full text can be found at: [www.ada.gov/2010ADASTandards\\_index.htm](http://www.ada.gov/2010ADASTandards_index.htm)

# CUSTOMIZE 4C MODULES TO FIT YOUR NEEDS

Not every installation has a standard solution and Florence is proud to support your custom needs. . .especially when it comes to private delivery solutions. So, whether you want a certain look that takes your installation to new heights by adding faux mailboxes (like this installation in New York, NY) or you need something outside the nearly 120 standard pre-configured mailbox modules, we can help.



Let your imagination soar with our industry unique online Revit mailbox configurator. Here, you can easily drag and drop mailboxes or swap compartment types, all at the click of your mouse. Visit [florencemailboxes.com/configure](http://florencemailboxes.com/configure) to get started.

## 4C Module Custom Compartment Options (All compartments are 12" W x 15" D)

Sometimes, a standard sized compartment is simply not big enough to suit your residents' needs; especially with the growing capacity needs for package delivery! That is why Florence's versatile™ 4C product line offers several different compartment types and sizes, all designed to accommodate increased capacity for your residents. Heights shown below are designed to replace corresponding number of regular sized tenant compartments (One-High); for example, a Two-High compartment replaces two One-High compartments.

	Tenant Compartments	Collection Compartments	Tenant Compartments with Drop Slot	Parcel Locker Compartments	
One-High (3" H)	MB1	OM1	DS1 *		
Two-High (6-1/2" H)	MB2	OM2	DS2 *		Standard Parcel Locker Compartment (15" H)
Three-High (10" H)	MB3	OM3	DS3 *	PL3 φ	PL5
Four-High (13-1/2" H)	MB4	OM4	DS4 *	PL4 φ	Six-High Parcel Locker Compartment (20-1/2" H)
Five-High (17" H)	MB5	OM5	DS5 *	PL5	PL6

\* For Private Delivery, Not USPS Approved  
Slot Dims: 1/2"H or 1"H x 9-5/8" W

φ For Private Delivery, unless parcel locker ratio exceeds requirement - see below for full details

φ To satisfy the USPS STD-4C 1:10 parcel locker to mailbox ratio requirement, parcel lockers (PL) must meet a minimum compartment height of 15". If the total number of PL in the mailbox installation exceeds the 1:10 requirement, smaller PL may also be included. For example: If a project requires 200 mailboxes, then at least 20 PL with a minimum size of 15"H x 12"W x 15"D must be included. But, if you add more than 20 PL to the 200 mailboxes, then you may also choose to incorporate some smaller PL into the installation. Be sure to note PL height when utilizing only one 4C module type in your entire installation as not all built-in lockers are 15" H and may require addition of parcel only modules to meet the 1:10 requirements (e.g. 4C13D-16).

# Installation Alternatives

## Options for STD-4C Mounting

### Recessed Mounting



All standard 4C modules are designed to be recessed into their mounting; whether it is directly into a wall, enclosure, or casing. The most common way to install the 4C modules is into a wall. Florence makes installation easy by providing a **Multi-Unit Connector Kit (MUCK)** for each specified module. This connector can be used to secure multiple units across a larger rough opening, eliminating the

need for studs. It also ensures your installation has a clean look as units are pulled together tightly so they are mounted flush to one another, reducing any potential gaps between modules.



### Surface Mounting



By utilizing the surface-mount collar, 4C modules can be installed flush onto a wall. This installation alternative is ideal for settings with limited wall depth or material that is difficult to cut in a rough opening - like brick or marble. The 4C module is simply mounted into an assembled collar to provide a finished, sleek look to your installation. (See page 33 for details.)

### Pedestal Mounting

Mounting a USPS Approved 4C module on a pedestal is not a Postal approved installation alternative, but is an excellent solution for any private delivery application. Pedestals are designed to ensure the selected module is installed at a standard accessible height, making installation quick and easy. (See details on pages 34 - 35.)



## Mailbox Enclosures Provide Greater Flexibility



### Surface-Mount Collars

Designed for indoor or outdoor use, Florence is pleased to offer a heavy-duty STD-4C mailbox enclosure which allows modules to quickly and easily be mounted to any flat surface. This smooth aluminum collar ensures the mail system achieves that desired sleek, finished look while easily attaching directly to the mailbox module. Ideal for settings with limited wall depth, this USPS Approved solution provides greater flexibility in your mailbox placement and installation.

### Product Features

- 4C collars are designed to fit and attach easily to ALL front-loading versatile™ 4C modules for both single- and double-wide configurations.
- All aluminum construction in rugged, weather-resistant powder coat finishes (see color options below).
- Easy-to-assemble collar has industry EXCLUSIVE slotted back designed for ease in installation and reduction of overall unit weight.



SM##D



SM##S

(Note: ## = selected suite height, e.g. SM14D)

### Color Options

Customize your surface mount collar with one of eight different architectural color options, all in a durable, powder coat finish.

Colors shown are representative of the actual powder coat finish but are limited by printing conditions and may vary slightly from finished product.



# Pedestal-Mounted Mailboxes

## *Added Flexibility for Private Delivery*



With all the same features and options, security, and durability of the Florence wall-mounted versatile™ 4C modules, pedestal mounting simply adds greater flexibility to your project as it is not tied to the USPS regulations. Designed to ensure every module is at a standard accessible height, pedestal-mount units come prepared with a master commercial lock to provide easy access to all compartments at once.

Ideal for centralized mail delivery applications where the USPS letter carrier delivers to a single location and the facility manager or entrusted individual then distributes the mail to the resident compartments.

## Product Applications

- Military Housing (*right*)
- Off-campus Student Housing
- On-campus Residence Halls
- Gated/Guarded Facility
- Book Collection
- Rent Payment Collection
- Multi-Media Drop Off
- Key Returns/Collection
- College Campus
- Private Medical Facility (*above*)
- Financial Institutions
- K-12 Schools



## Color Options

Customize your 4CPM with one of eight different architectural color options, all in a durable, powder coat finish.

Colors shown are representative of the actual powder coat finish but are limited by printing conditions and may vary slightly from finished product.



Antique Bronze (AB)



Black (BK)



Dark Bronze (DB)



Gold Speck (GS)



Postal Grey (PG)



Sandstone (SD)



Silver Speck (SS)



White (WH)



## Product Features

- versatile™ 4C modules mounted on a pedestal include the same robust product features outlined on pages 14-16.
- Any 4C Mailbox or accessory module offered by Florence may be mounted on a pedestal.
- Each 4C module is factory-installed in an aluminum outer casing for pedestal mounting.
- Matching aluminum pedestal provided with unit snaps on for convenient installation.

### This Product Distributed By:

**U.S. Mail Supply, Inc.**

3065 North 124th Street

Brookfield, WI 53005-3857

Ph: 800-571-0147 / Fax: 800-589-1068

www.usmailsupply.com



*Free-standing collection boxes may be approved for USPS collection if local postal officials authorize use and location.*

**NOTE:** To view all standard pre-configured pedestal-mounted module options, see pages 18 - 29. For Pedestal-Mount Module numbers, simply add "-P" to the end of the front-load module numbers shown. Listed weights in Quick Reference Guide are for modules only and do not include weight of pedestal or outer cabinet. Pedestal-mount module dimensions are listed below:

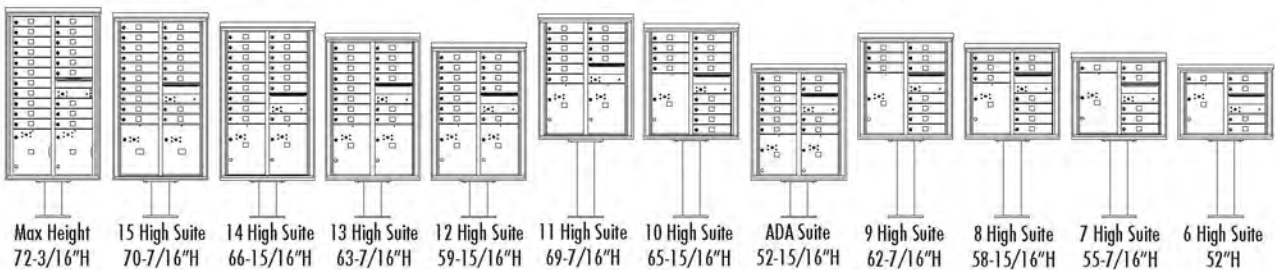

Overall pedestal-mount module dimensions: (Shown above) H x 32-13/16" W (Double) or 18-3/4" W (Single) x 17-3/4" D

## cluster box units

If your project calls for USPS Approved pedestal-mount units, be sure to check out the Florence vital™ cluster box unit product line. Complete with industry EXCLUSIVE units, decorative accessories, and additional parcel only units (pages 10-11), this line of outdoor delivery equipment will be sure to fill your needs.



1570-8



1570-12



1570-16



1570-13



1570-4T5



1570-8T6

**FLORENCE**  
EXCLUSIVE PRODUCT



# Collection Boxes

## for Letters or Packages



### versatile™ Collection Centers

Use this secure product for all your individual collection needs; whether that includes x-rays, DVD/Blu Rays, books, key drop, etc. for private collection, or as a wall-mounted version for postal collection. The patent pending hopper mechanism and collection box lock ensure contents remain safe and secure. Designed to be suitable for indoor or outdoor use, it is available in nine wall- or pedestal-mount heights.

### Standard Features

- Collection box units can be installed recess- or surface-mounted on a wall or with a pedestal
- Units designed to meet ADA/DOJ, ICC/ANSI, and IBC compliance for maximum 48" door access when installed 14-1/8" above the finished floor

**FLORENCE**  
EXCLUSIVE PRODUCT



- Industry unique designs seal off access to the main collection compartment when open to prevent mail fishing
- Once unit is full, hopper door will not open to accept more items

#### Did you know?

The Postal Regulation that pertains to collection centers is USPS Publication 16 and states local Postal Authorities must approve all units prior to installation.

### Color Options

Customize your versatile™ Collection Boxes with eight different architectural powder coat finishes.

Colors shown are representative of the actual powder coat finish but are limited by printing conditions and may vary slightly from finished product.



## Collection Box Selections

Florence is pleased to be the only manufacturer to have achieved USPS Approval status for its versatile™ 4C collection box. Designed to coordinate with the versatile™ 4C mailbox suites (see pages 18 - 29 for mailbox product details), select as many modules as needed for your project.



4C16S-HOP 4C15S-HOP 4C14S-HOP 4C13S-HOP 4C12S-HOP 4C11S-HOP 4C10S-HOP 4C09S-HOP 4C08S-HOP



4C16S-HOP 4C15S-HOP 4C14S-HOP 4C13S-HOP 4C12S-HOP 4C11S-HOP 4C10S-HOP 4C09S-HOP 4C08S-HOP

**Note:** Free-standing collection boxes for postal delivery must be pre-approved by local postal officials.



4C10S-HOP

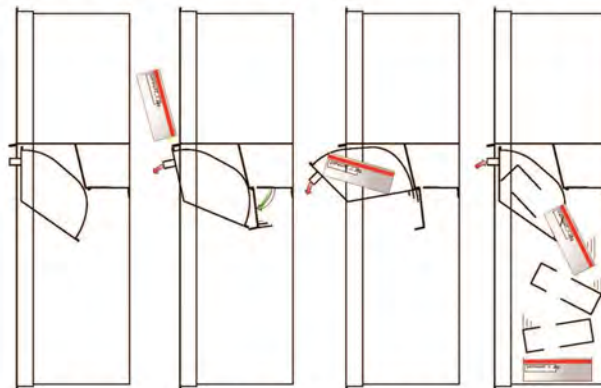

When open, collection door extends 5-7/16" from unit and seals off access to the main collection compartment. Once unit is full, collection door will not open to accept more items.



4CADS-HOP-P

# Collection Bins

## for Waste / Recycling



## versatile™ Trash / Recycling Bins

Since these bins were designed as part of the versatile™ 4C mailbox line, they are the perfect complement to your centralized mail center. Keep the area tidy by providing receptacles for the disposal of junk mail, or create a standalone recycling center for the convenience of your residents.

### Standard Features

- Constructed of heavy gauge aluminum and stainless steel components
- Included interior collection receptacle(s) constructed of all recycled materials
- Master door includes 5-pin cam lock with three keys
- Door flap in brushed stainless steel with pre-printed decals: WASTE, TRASH, PLASTIC, GLASS or PAPER
- Recessed-mount

### Standard Lock

The versatile™ 4C bins come standard with a 86009 lock.



86009

### Optional Features

- Custom door flap decals with up to 12 characters
- Keyless latch options
- Powder coat finish door flap in coordinating color
- Eight powder coat color finishes
- Four mounting options

### Color Options

Customize your versatile™ Collection Bin with eight different architectural powder coat finishes.



Antique Bronze (AB)



Black (BK)



Dark Bronze (DB)



Gold Speck (GS)



Postal Grey (PG)



Sandstone (SD)



Silver Speck (SS)



White (WH)

Colors shown are representative of the actual powder coat finish but are limited by printing conditions and may vary slightly from finished product.

## Bin Selections

Florence is pleased to be the provider of the versatile™ 4C trash/recycling bins. Designed to coordinate with the versatile™ 4C mailbox suites (see pages 18 - 29 for mailbox product details), select as many modules as needed for your project.



## Door Flap Decal Options

Choose from five standard decal options or create your own custom option with up to 12 characters.

**TRASH**

**WASTE**



**GLASS**



**PAPER**



**PLASTIC**

## Mounting Options

Three different mounting options provide greater flexibility in creating your recycling center or matching an existing mailbox installation:

- Recessed-mount (shown to right)
- Surface-mount collar (see page 33)
- Pedestal-mount (see pages 34 - 35)



Note: There are no mounting height requirements, but we suggest 14-1/8" to ensure doors meet possible 48" requirement.

# FLORENCE CORPORATION



**This Product Distributed By:**  
**U.S. Mail Supply, Inc.**  
3065 North 124th Street  
Brookfield, WI 53005-3857  
Ph: 800-571-0147 / Fax: 800-589-1068  
[www.usmailsupply.com](http://www.usmailsupply.com)



## **Powering Your Commercial and Residential Centralized Mailbox Designs for Over 80 Years!**

**Florence Corporation. Established. Dependable. Strong.**

Like all great stories, ours started in a garage. Elbow grease, a sweaty brow. It's that kind of story. More than 80 years later, we're still hard at it; continually perfecting our craft, allowing you to perfect yours. You may take our products for granted. We take that as a compliment. Our products don't require attention or fuss. They're built smart, designed to work, and engineered to last.

We empower our customers with the products, the support, and the tools to design faster. Build smarter. Manage better. We understand that in a world of global commerce, demands of efficiency and last minute deadlines, you need a partner that can keep pace. You've met your match with Florence. Established. Dependable. Strong. It's not just what we make...it's what makes us.