

versatile™ 4C Surface Mount Collar, SM15D

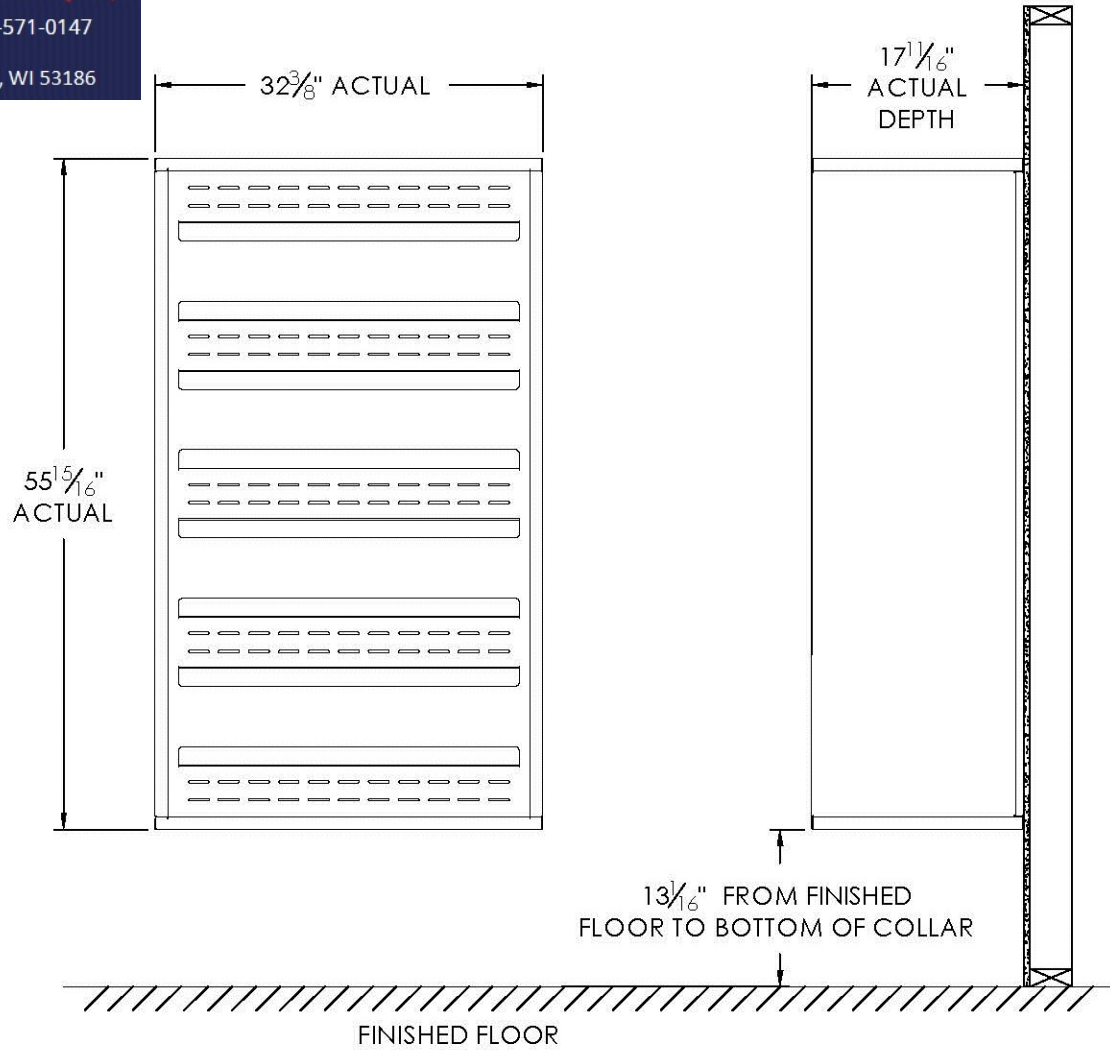

Notes:

1. Designed to mount Florence Versatile™ 4C mailbox double column 15-High Suite modules (sold separately).
2. For use with front loading modules only.

PRODUCT SERIES: VERSATILE™ 4C SURFACE MOUNT COLLAR

**AF FLORENCE**  
manufacturing company

5935 Corporate Drive • Manhattan, KS 66503  
www.florencemailboxes.com • (800) 275-1747

A GIBRALTAR INDUSTRIES COMPANY

MODEL	SM15D	REV	B
SCALE	NONE	LAST REV DATE	07/02/2014
DRAWING NUMBER	SM15DCS	DRAWN BY	TNS