

vital™ Cluster Box Unit - Type II

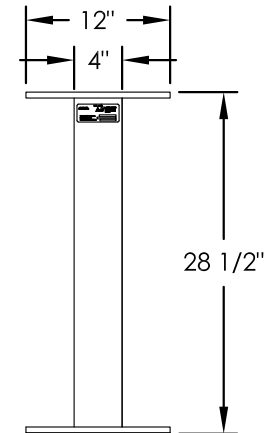

PEDESTAL

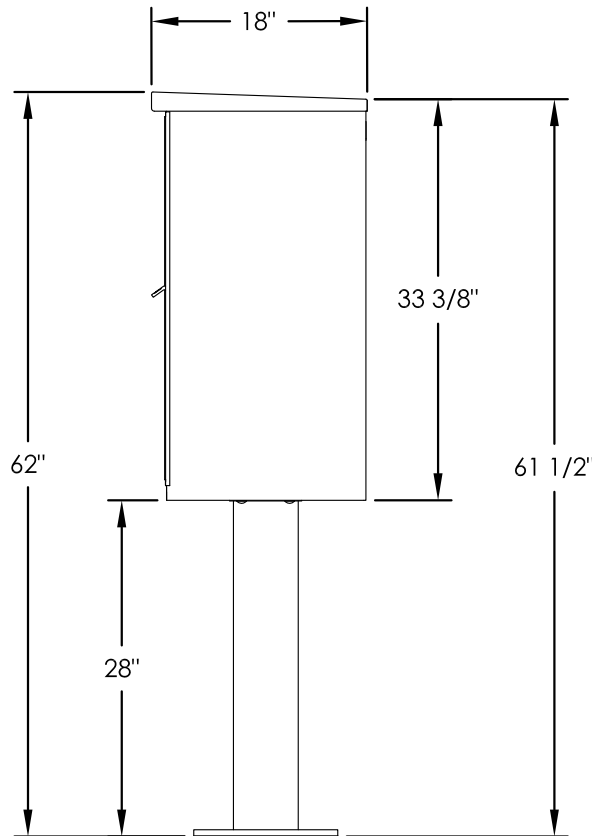
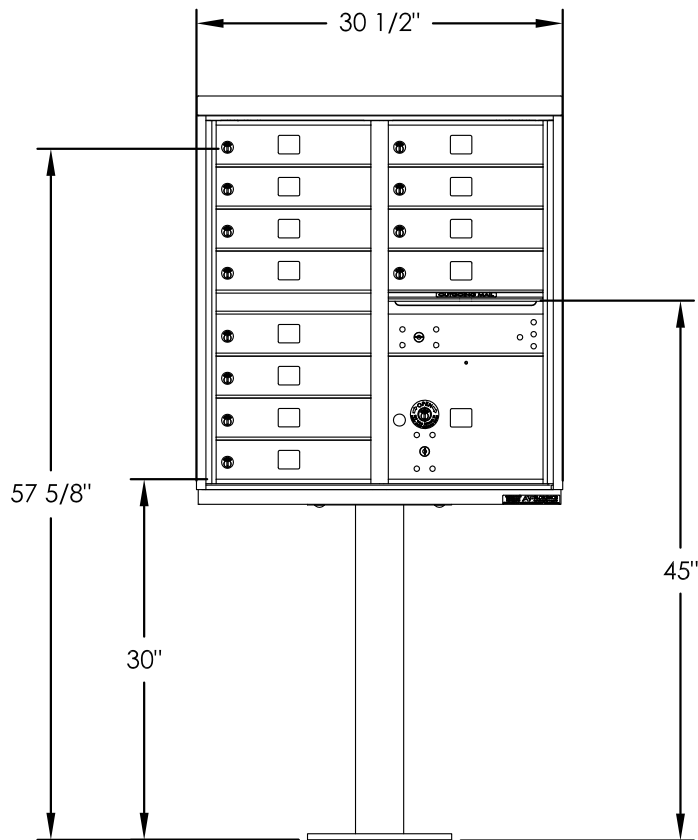
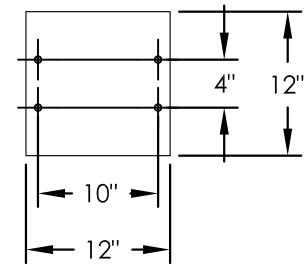

PEDESTAL BASE
BOLT PATTERN

SIDE VIEW

DOOR CHART

DOOR TYPE	DIMENSION (HEIGHT x WIDTH)
TENANT	3-3/8" x 12-13/16"
10" PARCEL	10-1/4" x 12-13/16"
OUTGOING SLOT	3/4" x 11-3/4"

U.S. MAIL SUPPLY
America's Mailbox Headquarters

262-782-6510 Toll Free: 800-571-0147

1553 E. Racine Ave. Waukesha, WI 53186

NOTES:

1. This unit is approved for USPS and private applications.
2. Decorative mailbox accessories sold separately and are USPS Approved products.
3. Pedestal should be installed with included Rubber Pad; mounting hardware not included, refer to installation manual for recommendations.
4. Florence "F" series CBU is Officially Licensed by USPS: License #CDSEQ-08-B-0012.

PRODUCT SERIES: vital™ CLUSTER BOX UNIT

AF FLORENCE
manufacturing company

5935 Corporate Drive • Manhattan, KS 66503
www.florencemailboxes.com • (800) 275-1747

A GIBRALTAR INDUSTRIES COMPANY

MODEL 1570-12	REV A
SCALE NONE	LAST REV DATE 9/26/2012
DRAWING NUMBER 1570-12CS	DRAWN BY AFD